



Baler Dimensions

Height	2 550mm
Width	1 610mm
Length	5 855mm
Weight	6.5T
Feed Opening	1 250mm x 1 050mm

Bale Dimensions

Height	750mm
Width	1 100mm
Length	1 200mm
Weight (material dependent)	up to 500kg
Number of ties	4

Features

- Full bale ejection of each bale
- High-pressure and low-pressure baling modes
- Vertical hydraulic end door
- Bale counter, hour meter
- Hardox plated floor and press plate base
- V shaped serrated bale chamber shear blades
- Low level machine (loading height)
- High density mill sized bales

Optional Extras

- Fast cycle options from 60 – 40 seconds
- Range of power pack and motor options
- Bin Tipper for infeed
- Custom hopper design
- Auto start/stop functions
- Paint upgrade – custom colours

Performance

Power Supply	415 V 3-Phase
Motor	5.5kW 32A
Pressing Force	38T
Cycle Time	60 seconds

[More product info on our website >>](#)



Dimensions and technical information without obligation. Subject to change.

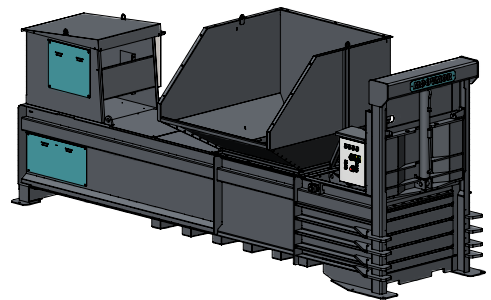
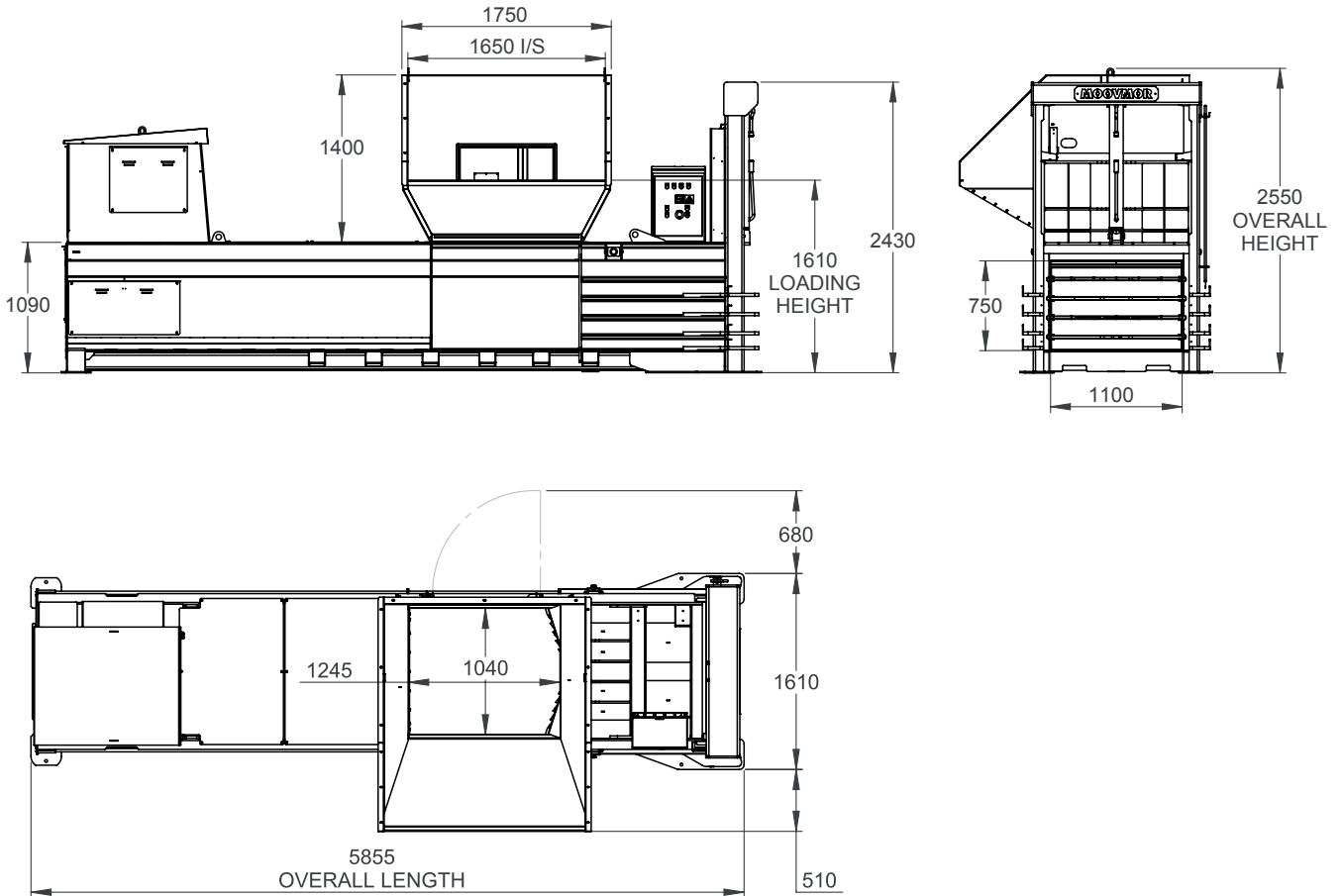

Size Comparison



Bale Weight
Up to 500 Kg



Pressing Force
Up to 38 Ton

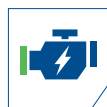

Motor
5.5kW 32A



Waste Types
Cardboard,
General Waste &
Processed Food

